

# OLYMPUS WARMER II

ITEM: \_\_\_\_\_ QUANTITY: \_\_\_\_\_

## MODEL # SCASH-II

SCASH-II - Shown with optional tray slide.  
Shown with round top.

### SPECIFICATIONS

The SCASH-II is a metal framed base heated self-service display case with individually controlled warming shelves. Available with a choice of standard grade plastic laminate exterior ends.



Available depths:  32"

Available lengths:  48"  60"  72"

### STANDARD FEATURES

- 2 Tier Individually Controlled Heated Shelves with Lights Preset to 145°
- Heated Deck Preset to 145°
- Top Canopy Light
- Squared Top Canopy
- Stainless Interior Back Panel
- Standard Grade Laminated Exterior

### OPTIONAL FEATURES

- Special Laminates
- Wood Veneers (Unfinished)
- Wood Veneers (Stained & Sealed)
- Miscellaneous Trim
- Promolux Lighting (Low UV)
- S/S Mirrored Polished Rear Interior Panel
- Mirrored Polished Stainless Steel Interior Ends
- Finished Back

### WHEN ORDERING, PLEASE SPECIFY:

APPLICATION: \_\_\_\_\_

LAMINATE COLOR: \_\_\_\_\_

# OLYMPUS WARMER II

TOLL FREE: 800-525-3692

## MODEL # SCASH II

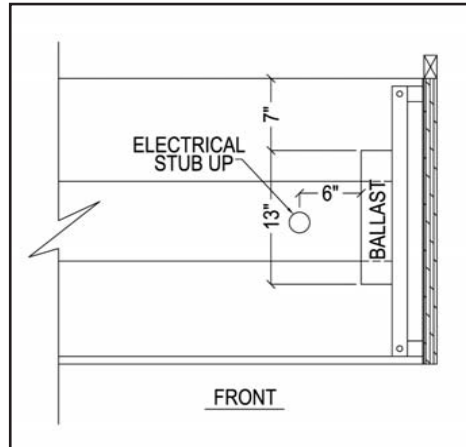
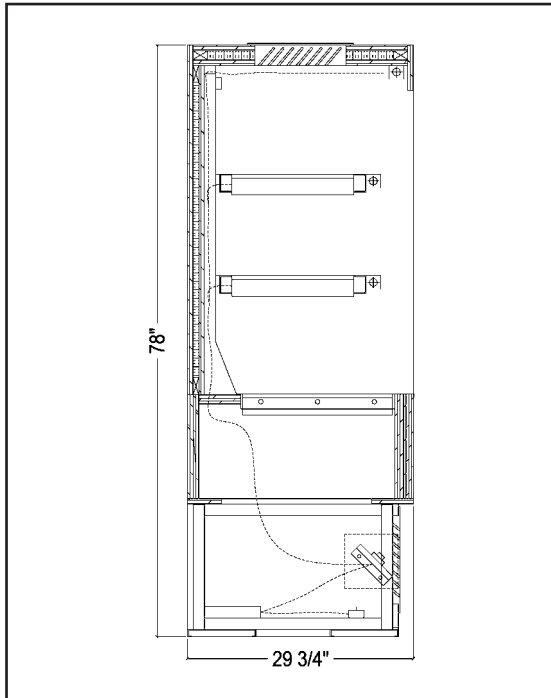

### Electrical & Plumbing locations

Refrigerated Case Display 67C9 Listed  
 Also classified by Underwriters Laboratories Inc.  
 In Accordance with ANSI/NSF 7-1999 and ANSI/NSF 2-1999

MODEL	L	D	H	VOLT	AMP	NEMA PLUG	WT
SCAS48H-II	48	32	78	120	18.7	5-20P	900
SCAS60H-II	60	32	78	120	21.1	5-30P	1020
SCAS72H-II	72	32	78	120	25.8	Hardwire	1150

The SCASH-II merchandiser is designed for use in stores where temperature and humidity do not exceed 75 degrees F and 55% R. H. Locate away from direct sunlight, rapid air currents and extreme temperature changes. Exposure to air currents from ceiling fans, air conditioners, ovens, etc. will disrupt the case's air curtain and refrigerated zone. Any adverse conditions will affect warranty.

RPI in line with it's policy to continually improve it's product reserves the right to change materials and specifications without notice.

CALL TOLL FREE: 800-525-3692 (609-714-2330)

FAX: 609-714-2331 [www.regalpinnacle.com](http://www.regalpinnacle.com)

220 ROUTE 70, MEDFORD, NJ 08055

