



Project _____
 Item # _____
 Quantity _____

Narrow Xenon Display Lights

Models: NLX-18, -24, -36, -42, -48, -54, -60, -66, -72

Narrow Xenon Display Lights are Hatco's new narrow-style that is ideal for installation in tight spaces, with a height of only 2.125" (54 mm) and 4" (102 mm) depth. The Xenon light bulbs provide bright display lighting that brings focus on the product below.

Standard features

- Available in widths from 18" to 72" (457-1829 mm).
- Supplied with non-adjustable 1.5" (38 mm) angle brackets for under-shelf mounting
- Control is housed in a remote-mounted control box with an On/Off toggle switch or optional dimmer switch with two conduits with 6" leads
- Optional *Designer* powdercoated colors, Gloss finishes, Plated finishes, and Stainless Steel housing available

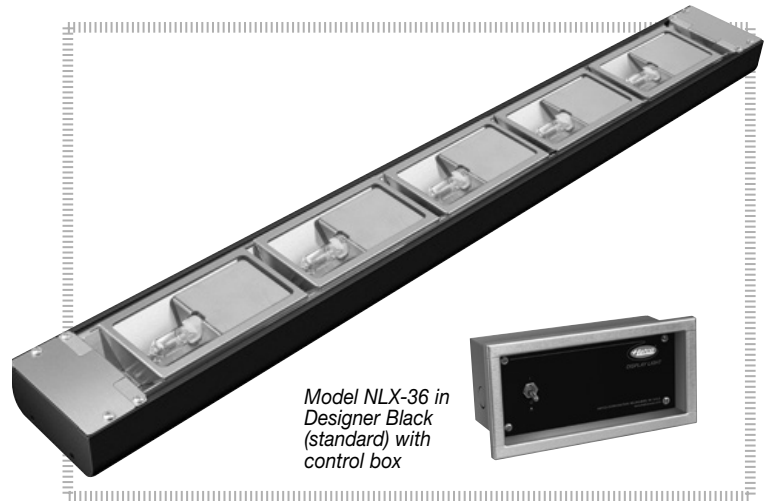

Model NLX-36 in Designer Black (standard) with control box

Options (available at time of purchase only)

- Designer Colors* (Nonstandard colors are non-returnable)
 - Warm Red Black (standard) Gray Granite White Granite
 - Navy Blue Hunter Green Antique Copper
- Gloss Finishes* (Nonstandard colors are non-returnable)
 - Smooth White Gleaming Gold Glossy Gray Bold Black
- Plated Finishes* (Special process required and extended lead times, non-standard colors are non-returnable)
 - Bright Brass Bright Nickel Bright Copper
 - Antique Nickel Antique Brass Antique Bronze
- All Stainless Steel Exterior (Nonstandard colors are non-returnable)
- Extended Electrical Leads – For any SU, SL, or SR mount unit, must specify lead length
 - 1'-5" (305-1525 mm) 6'-10" (1829-3048 mm)
 - 11'-15" (3352-4572 mm) 16'-20" (4877-6096 mm)
- Power Locations
 - Left Right
- Control Options
 - Toggle (Standard) Dimmer Control
 - Without controls Remote Toggle
- Flush Mount Control Box Bezel in:
 - Warm Red Black (Standard) Gray Granite White Granite
 - Navy Blue Hunter Green Antique Copper
 - Stainless Steel
- Non-adjustable Tubular Stands with a clearance of:
 - 10" or 12" (254-305 mm) 14'-16" (356-406 mm)
- Non-adjustable Tubular Stand Color Choice:
 - Aluminum (standard)
 - Designer Colors* (Nonstandard colors are non-returnable)
 - Warm Red Black Gray Granite White Granite
 - Navy Blue Hunter Green Antique Copper
 - Gloss Finishes* (Nonstandard colors are non-returnable)
 - Smooth White Gleaming Gold Glossy Gray Bold Black



HATCO CORPORATION | P.O. Box 340500 Milwaukee, WI 53234-0500 U.S.A. | (800) 558-0607 | (414) 671-6350
 Fax: (800) 543-7521 | Int'l. Fax: (414) 671-3976 | www.hatcocorp.com | email: equipsales@hatcocorp.com



Narrow Xenon Display Lights

Models: NLX-18, -24, -36, -42, -48, -54, -60, -66, -72

NLX-XX

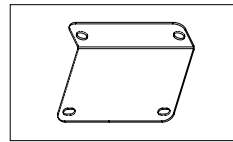
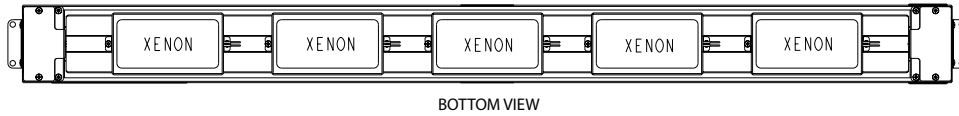
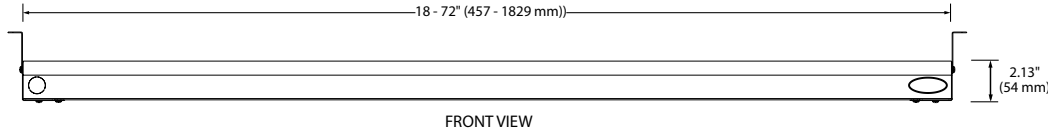
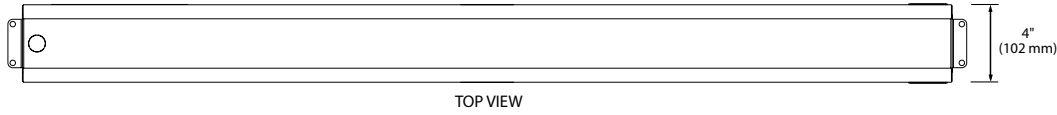

Non-Adjustable Angle Bracket

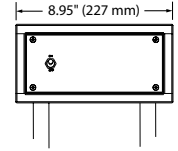

Standard Toggle Control Box

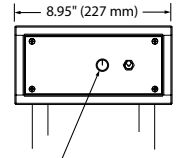

Optional Dimmer Control Box

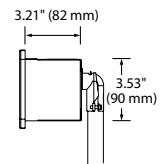

Toggle or Dimmer Side View

Cutout Dimensions for Standard Toggle or Optional Dimmer Control Box
8.125" x 3.875" (206 x 98 mm)

SPECIFICATIONS Narrow Xenon Display Lights

Model	Dimensions (Width x Depth x Height)	Xenon Bulbs	Volts	Phase	Watts	Amps	Ship Weight*
NLX-18	18" x 4" x 2 1/8" (457 x 102 x 54 mm)	2	120	Single	100	.8	8 lbs. (4 kg)
NLX-24	24" x 4" x 2 1/8" (610 x 102 x 54 mm)	3	120	Single	150	1.3	9 lbs. (4 kg)
NLX-30	30" x 4" x 2 1/8" (762 x 102 x 54 mm)	3	120	Single	150	1.3	11 lbs. (5 kg)
NLX-36	36" x 4" x 2 1/8" (914 x 102 x 54 mm)	5	120	Single	250	2.1	13 lbs. (6 kg)
NLX-42	42" x 4" x 2 1/8" (1067 x 102 x 54 mm)	5	120	Single	250	2.1	13 lbs. (6 kg)
NLX-48	48" x 4" x 2 1/8" (1219 x 102 x 54 mm)	5	120	Single	250	2.1	14 lbs. (6 kg)
NLX-54	54" x 4" x 2 1/8" (1372 x 102 x 54 mm)	7	120	Single	350	2.9	16 lbs. (7 kg)
NLX-60	60" x 4" x 2 1/8" (1524 x 102 x 54 mm)	7	120	Single	350	2.9	18 lbs. (8 kg)
NLX-66	66" x 4" x 2 1/8" (1676 x 102 x 54 mm)	9	120	Single	450	3.8	20 lbs. (9 kg)
NLX-72	72" x 4" x 2 1/8" (1829 x 102 x 54 mm)	9	120	Single	450	3.8	21 lbs. (10 kg)

* Shipping weight includes packaging.

PRODUCT SPECS Narrow Xenon Display Lights

The Narrow Display Lights with xenon, manufactured by the Hatco Corporation, Milwaukee, WI 53234 U.S.A. With 24/7 service (U.S. and Canada only), the Narrow Display Lights with xenon shall be ... , rated at ... watts, ... volts, single phase and be ... inches (millimeters) in overall width.

The Display Lights shall consist of Stainless Steel, Designer, Gloss, or Plated finish housing and include as standard equipment non-adjustable 1.5" (38 mm) angle brackets.

The light shall be factory assembled ready for electrical installation.

Options shall include, extended electrical leads, non-adjustable tubular stands, and includes xenon lights.

HATCO CORPORATION | P.O. Box 340500 Milwaukee, WI 53234-0500 U.S.A. | (800) 558-0607 | (414) 671-6350

Fax: (800) 543-7521 | Int'l. Fax: (414) 671-3976 | www.hatcocorp.com | email: equipsales@hatcocorp.com