



Project _____
 Item # _____
 Quantity _____

Narrow LED Display Lights

Models: NLL-30, -36, -42, -48, -54, -60

Narrow LED Display Lights are Hatco's newest narrow-style that is ideal for installation in tight spaces, but emit little or no heat. Providing a bright display area, the LED lighting is ideal above refrigerated product areas where an attractive glow is needed to enhance your food products. This lighting will deliver significant savings because of lower energy consumption, longer bulb lifetime and greater reliability.

Standard features

- Available in widths from 30" to 60" (762 to 1524 mm)
- 120 volt, single phase only with On/Off rocker switch
- Supplied with non-adjustable 1.5" (38 mm) angle brackets for under-shelf mounting
- Optional *Designer* powdercoated colors, Gloss finishes, Plated finishes, and Stainless Steel housing available
- 6" (152 mm) Leads (no conduits)

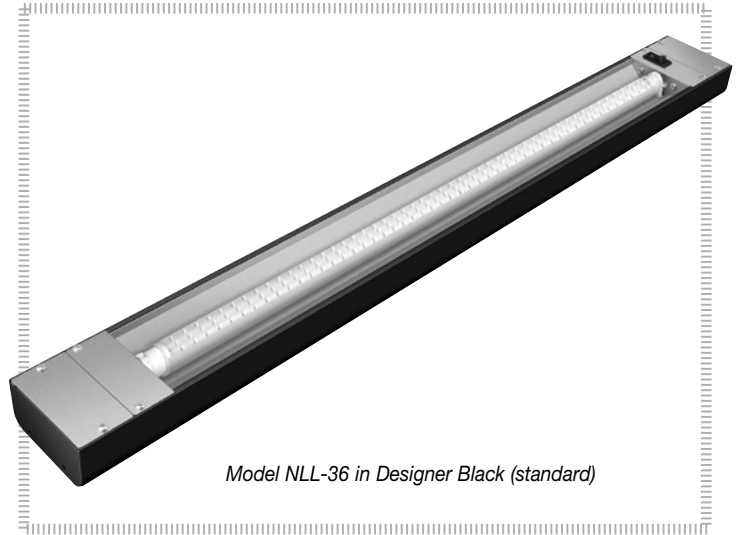

Model NLL-36 in Designer Black (standard)

Options (available at time of purchase only)

- Designer* Colors (Nonstandard colors are non-returnable)
 - Warm Red Black (standard) Gray Granite White Granite
 - Navy Blue Hunter Green Antique Copper
- Gloss Finishes (Nonstandard colors are non-returnable)
 - Smooth White Gleaming Gold Glossy Gray
 - Bold Black
- Plated Finishes (Special process required and extended lead times, non-standard colors are non-returnable)
 - Bright Brass Bright Nickel Bright Copper
 - Antique Nickel Antique Brass Antique Bronze
- All Stainless Steel Exterior (Nonstandard colors are non-returnable)
- Extended Electrical Leads – For any SU, SL, or SR mount unit, must specify lead length)
 - 1'-5' (305-1525 mm) 6'-10' (1829-3048 mm)
 - 11'-15' (3352-4572 mm) 16'-20' (4877-6096 mm)
- Power Locations
 - Left Right
- Non-adjustable Tubular Stands with a clearance of:
 - 10" or 12" (254-305 mm) 14'-16" (356-406 mm)
- Non-adjustable Tubular Stand Color Choice:
 - Aluminum (standard)
 - Designer* Colors (Nonstandard colors are non-returnable)
 - Warm Red Black Gray Granite White Granite
 - Navy Blue Hunter Green Antique Copper
 - Gloss Finishes (Nonstandard colors are non-returnable)
 - Smooth White Gleaming Gold Glossy Gray
 - Bold Black



HATCO CORPORATION | P.O. Box 340500 Milwaukee, WI 53234-0500 U.S.A. | (800) 558-0607 | (414) 671-6350
 Fax: (800) 543-7521 | Int'l. Fax: (414) 671-3976 | www.hatcocorp.com | email: equipsales@hatcocorp.com



Narrow LED Display Lights

Models: NLL-30, -36, -42, -48, -54, -60

NLL-XX

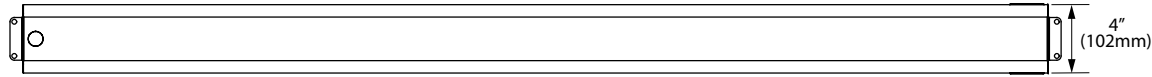

TOP VIEW

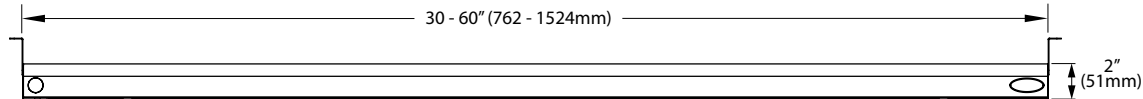

FRONT VIEW

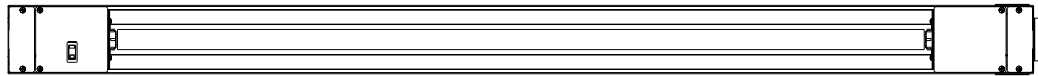

BOTTOM VIEW



END VIEW

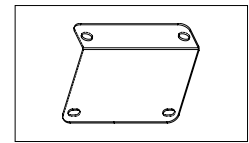

Non-Adjustable Angle Bracket

SPECIFICATIONS Narrow LED Display Lights

Model	Dimensions (Width x Depth x Height)	Bulb Length	Volts	Phase	Watts	Amps	Ship Weight*
NLL-30	30" x 4" x 2" (762 x 102 x 51 mm)	2' (610 mm)	120	Single	10	.08	7 lbs. (3 kg)
NLL-36	36" x 4" x 2" (914 x 102 x 51 mm)	2' (610 mm)	120	Single	10	.08	8 lbs. (4 kg)
NLL-42	42" x 4" x 2" (1067 x 102 x 51 mm)	3' (914 mm)	120	Single	14	.12	9 lbs. (4 kg)
NLL-48	48" x 4" x 2" (1219 x 102 x 51 mm)	3' (914 mm)	120	Single	14	.12	10 lbs. (5 kg)
NLL-54	54" x 4" x 2" (1372 x 102 x 51 mm)	4' (1219 mm)	120	Single	20	.17	11 lbs. (5 kg)
NLL-60	60" x 4" x 2" (1524 x 102 x 51 mm)	4' (1219 mm)	120	Single	20	.17	12 lbs. (6 kg)

* Shipping weight includes packaging.

PRODUCT SPECS Narrow LED Display Lights

The Narrow LED Display Lights, manufactured by the Hatco Corporation, Milwaukee, WI 53234 U.S.A. With 24/7 service (U.S. and Canada only), the Narrow LED Display Lights shall be ... , rated at ... watts, ... volts, single phase and be ... inches (millimeters) in overall width.

The Narrow LED Display Lights shall consist of Stainless Steel, Designer, Gloss, or Plated finish housing and include as standard equipment non-adjustable 1½" (38 mm) angle brackets.

The light shall be factory assembled ready for electrical installation.

Options shall include extended electrical leads, and non-adjustable tubular stands.

HATCO CORPORATION | P.O. Box 340500 Milwaukee, WI 53234-0500 U.S.A. | (800) 558-0607 | (414) 671-6350

Fax: (800) 543-7521 | Int'l. Fax: (414) 671-3976 | www.hatcocorp.com | email: equipsales@hatcocorp.com