



# GLO-RAY® CURVED MERCHANDISING WARMERS

Models GRMCW-1, -1D, -1DH

The Glo-Ray® Curved Merchandising Warmer offers a unique and attractive solution for impulse merchandising a wide variety of food products. The unit's attractive design adds a touch of class to any restaurant, hotel, convenience store, or grab-n-go retail market setting.

## FLEXIBILITY

The Hatco GRMCW-1 single shelf unit is ideal for holding food safely at customer serving points. The xenon lights and heating elements are controlled by the main switch making start up and shut down a one touch operation. The warmer's attractive food stop, side glass enclosures, and back mirror glass panel are removable for cleaning.

The Hatco GRMCW-1D, -1DH dual shelf units features one lower front polycarbonate access door, side glass enclosures, an upper breath protector, and the top shelf holds two ½ size pans or one full size pan. The bottom shelf holds two ½ size pans, with or without humidity.

## QUALITY

The following features assure the finest performance for years to come:

- Designer colors for unit's painted surface (no decorative trim accents) available in seven color options to coordinate the warmer with any décor. Non-standard colors are non-returnable.
- Four Decorative Stone colors for unit's painted surface and decorative trim accents: Gray Granite, Bermuda Sand, Night Sky, and Sawgrass. Non-standard colors are non-returnable.
- Single shelf and dual shelf units come standard with mirrored glass back panel.
- Xenon lighting allows for optimal food product display. Export voltage models use halogen lighting.
- Individual thermostatically-controlled heated base with master rocker switch maintains safe serving temperatures.
- Humidified dual shelf unit contains a five cup (1.18 liter) capacity water reservoir.
- All models are shipped with 1" (25 mm) adjustable legs and factory attached 6' (1829 mm) cord and plug.
- Optional top shelf flip-up door in lieu of sneeze guard.
- Optional sign holders available for top, intermediate, and bottom shelves.

Equipment  
On Signage Program  
[Hatcographics.com](http://Hatcographics.com)



Model GRMCW-1D with optional Bermuda Sand Decorative Stone color, flip-up door on top shelf, and accessory sign holders



Model GRMCW-1 in Designer Black with accessory food pans



Model GRMCW-1DH in Designer Black with accessory food pans



ONE YEAR ON-SITE PARTS AND LABOR WARRANTY, PLUS ONE ADDITIONAL YEAR PARTS-ONLY WARRANTY ON ALL GLO-RAY METAL SHEATHED HEATING ELEMENTS.

HATCO CORPORATION P.O. Box 340500 Milwaukee, WI 53234-0500 U.S.A.  
(800) 558-0607 • (414) 671-6350 • Fax (800) 543-7521 • Int'l. Fax (414) 671-3976  
[www.hatcocorp.com](http://www.hatcocorp.com) • E-mail: [equipsales@hatcocorp.com](mailto:equipsales@hatcocorp.com)

Form No. GRMCW Spec Sheet

Printed in U.S.A.  
October 2012



# GLO-RAY<sup>®</sup> CURVED MERCHANDISING WARMERS

Models GRCMW-1, -1D, -1DH

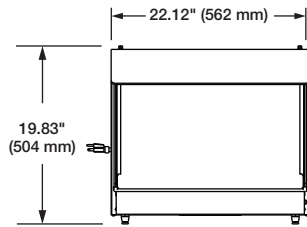

FRONT VIEW

Model GRCMW-1 – Single Shelf

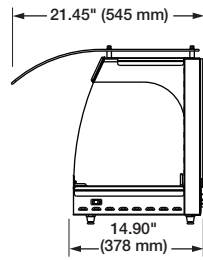

SIDE VIEW

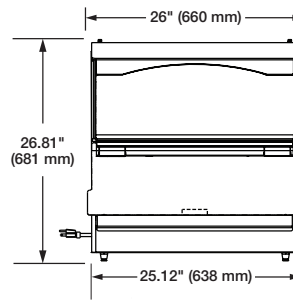

FRONT VIEW

Model GRCMW-1D &amp; GRCMW-1DH – Dual Shelf

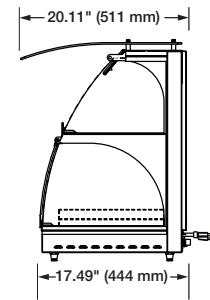

SIDE VIEW

## SPECIFICATIONS

### Single Shelf

Model	Watts	Amps	Width	Shipping Weight
GRCMW-1	670	5.6	22.12" (524 mm)	56 lbs. (25 kg)

### Dual Shelf

Model	Watts	Amps	Width	Shipping Weight
GRCMW-1D	1540	12.8	26" (660 mm)	95 lbs. (43 kg)

### Dual Shelf with Humidity<sup>‡</sup>

Model	Watts	Amps	Width	Shipping Weight
GRCMW-1DH	1660	13.8	26" (660 mm)	100 lbs. (45 kg)

<sup>‡</sup> Humidity on bottom shelf only.

## DIMENSIONS

### GRCMW-1 Single Shelf Model:

22.12"W x 21.45"D x 19.83"H (562 x 545 x 504 mm).

### GRCMW-1D & -1DH Dual Shelf Models:

26"W x 20.11"D x 26.81"H (660 x 511 x 681 mm).

Water Capacity: 5 cups (1.18 liters).

## VOLTAGE

GRCMW-1: 120 volts, 60 Hz (uses NEMA 5-15P).

GRCMW-1D: 120 volts, 60 Hz (uses NEMA 5-15P)  
(uses NEMA 5-20P for Canada).

GRCMW-1DH: 120 volts, 60 Hz (uses NEMA 5-15P)  
(uses NEMA 5-20P for Canada).

Export voltages available.

## CORD LOCATION

Control side at right base corner.

## PLUG CONFIGURATIONS

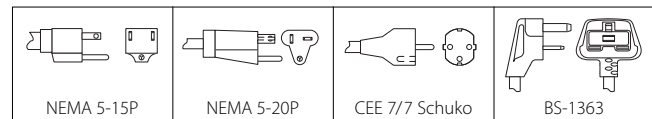

## OPTIONS (NOT FOR RETROFIT)

- Designer Colors on Unit: Warm Red, **Black (standard)**, Gray Granite, White Granite, Navy Blue, Hunter Green, Antique Copper, non-standard colors are non-returnable
- Decorative Stone Colors on Unit and on Insets: Gray Granite, Bermuda Sand, Night Sky, Sawgrass, non-standard colors are non-returnable
- Flip-up door on customer side, in lieu of sneeze guard (GRCMW-1 only)
- Top and Bottom Shelf Flip-Up Doors on server's side, in lieu of mirrored back panel (GRCMW-1D, -1DH Models only)
- Fixed front door panel, must be ordered with CMWDBACKFLIP, one per level, customer side (GRCMW-1D, -1DH Models only)

- Top Shelf Flip-Up Door on customer side, in lieu of sneeze guard (GRCMW-1D, -1DH models only)
- Base Skirts
- Upper Shelf Skirt (GRCMW-1D, 1DH models only)
- Display Sign Holders (Signs not included)

## ACCESSORIES

- Stainless Steel & Plastic Food Pans
- Wire Trivets – Stainless Steel or Plated

## PRODUCT SPECS

### Curved Merchandising Warmer

The Curved Merchandising Warmer shall be a Glo-Ray<sup>®</sup> Model ... as manufactured by the Hatco Corporation, Milwaukee, WI 53234 U.S.A.

The warmer shall be rated at ... watts, ... volts and be ... inches (millimeters) in overall width. It shall consist of a thermostatically-controlled heated base, full view tempered glass sides, and xenon display lights. Export voltage models use halogen lights.

The infrared heating element shall be tubular metal sheathed and the warmer shall have a cord with plug attached.

Accessories shall include top shelf door, flip-up doors, display sign holders, stainless steel and plastic food pans, wire trivets, and pan skirts. One year on site parts and labor warranty, plus one additional year warranty on all metal sheathed heating elements, with 24/7 service (U.S. and Canada only).

**HATCO CORPORATION P.O. Box 340500 Milwaukee, WI 53234-0500 U.S.A. • (800) 558-0607 • (414) 671-6350**  
**Fax (800) 543-7521 • Int'l. Fax (414) 671-3976 • www.hatcocorp.com • E-mail: equipsales@hatcocorp.com**