

ROUGH-IN:

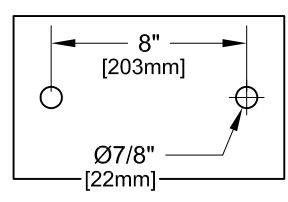

PRODUCT NAME: STAINLESS STEEL
8" DECK MOUNT PRE-RINSE WITH ADD-ON

MODEL:

- 68225 6" SWING SPOUT W/ LEVER HANDLES
- 68233 8" SWING SPOUT W/ LEVER HANDLES
- 68241 10" SWING SPOUT W/ LEVER HANDLES
- 68268 12" SWING SPOUT W/ LEVER HANDLES
- 68276 14" SWING SPOUT W/ LEVER HANDLES
- 68284 16" SWING SPOUT W/ LEVER HANDLES
- 75450 6" SWING SPOUT W/ WRIST HANDLES
- 75469 8" SWING SPOUT W/ WRIST HANDLES
- 75477 10" SWING SPOUT W/ WRIST HANDLES
- 75485 12" SWING SPOUT W/ WRIST HANDLES
- 75493 14" SWING SPOUT W/ WRIST HANDLES
- 75507 16" SWING SPOUT W/ WRIST HANDLES

FEATURES:

- CONTROL VALVE**
- * 8" DECK MOUNT
 - * STAINLESS STEEL CONSTRUCTION
 - * SWIVELLING SEAT DISKS
 - * HOT SIDE STEM - RIGHT HAND
 - * COLD SIDE STEM - LEFT HAND
 - * LEVER HANDLES OR WRIST HANDLES

- ADD-ON CONTROL VALVE**
- * STEM - RIGHT HAND SWIVEL
 - * HOT INDEX BUTTON
 - * SWIVELLING SEAT DISKS
 - * STAINLESS STEEL SEATS, SEAT SCREWS AND HANDLE SCREWS.

- HOSE**
- * 36" LENGTH
 - * STAINLESS STEEL END FITTINGS
 - * STAINLESS STEEL EXTERNAL JACKET
 - * 3-PLY FIBER REINFORCED INTERNAL RUBBER HOSE
 - * REPAIRABLE IN FIELD WITH SIMPLE TOOLS

- ULTRA SPRAY VALVE**
- * LOWEST ENERGY USER - 1.15 GPM @ 60 PSI
 - * CLEANS FASTER - TEST PROVEN
 - * ENGINEERED TO LAST - NO 'O' RINGS TO LEAK
 - * INTERCHANGEABLE - FITS ALL BRANDS

- WALL BRACKET**
- * ADJUSTS FROM 2" TO 12"

- SYSTEM LIMITS**
- * TEMP: 40°F MIN. TO 140°F MAX. STATIC
 - * PRESSURE 200 PSI MAX. STATIC
 - * SHIPPING WEIGHT: 15.0 LBS

* NSF 61-9 APPROVED & LISTED
www.truesdail.com



FISHER MANUFACTURING COMPANY
TOLL FREE: 800-421-6162 - FAX: 800-832-8238
information@fisher-mfg.com - www.fisher-mfg.com