

APPLICATION:

JOB NAME:

QUANTITY:                      ITEM NO.

PRODUCT NAME:            STAINLESS STEEL  
8" ADJ. WALL MOUNT HOSE STYLE  
POT FILLER

SPECIAL CONFIGURATION  
 24171    CHECK BASE MODEL AND OPTIONS

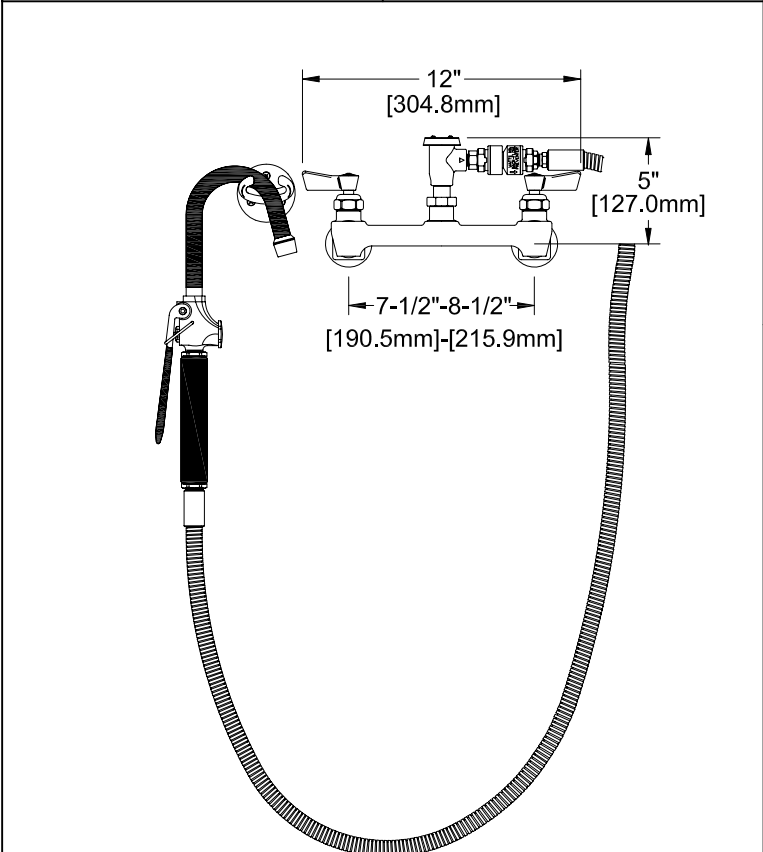

- OPTIONS OR MODIFICATIONS:
- SUPPLY LINES (24" OR 36") CIRCLE LENGTH
  - ADD-ON FAUCET (6",8",10",12",14",16") CIRCLE LGTH
  - IN-LINE DUAL CHECK VALVE
  - PIPE HOOK
  - NIPPLES
  - ELBOWS
  - VANDAL RESISTANT KIT
  - HANDLES (CROSS OR WRIST) CIRCLE STYLE
  - OTHER    48" HOSE FG

- FEATURES:
- CONTROL VALVE**
- \* ECCENTRICS ADJUST FROM 7-1/2" TO 8-1/2"
  - \* INTERNAL SPRING LOADED CHECK VALVES
  - \* SWIVELLING SEAT DISKS
  - \* HOT SIDE STEM - RIGHT HAND
  - \* COLD SIDE STEM - LEFT HAND
  - \* STAINLESS STEEL SEATS
  - \* STAINLESS STEEL SEAT SCREWS
  - \* STAINLESS STEEL HANDLE SCREWS
- HOSE**
- \* 48" LENGTH
  - \* STAINLESS STEEL END FITTINGS
  - \* STAINLESS STEEL EXTERNAL JACKET
  - \* BRAIDED USDA APPROVED FOODGRADE INTERNAL HOSE
  - \* REPAIRABLE IN FIELD WITH SIMPLE TOOLS
- POT FILLER VALVE**
- \* NON-SCRATCHING/ MARRING TUBE
  - \* 5.0 GPM AT 80 PSI
  - \* AERATED STREAM
- SWIVEL VACUUM BREAKER**
- \* 360° TURNING RADIUS
  - \* ATMOSPHERIC VACUUM BREAKER
- SYSTEM LIMITS**
- \* TEMP: 40°F MIN. TO 140°F MAX.
  - \* PRESSURE 200 PSI MAX. STATIC
- SHIPPING WEIGHT**
- \* 11.5 LBS
- NSF 61-9 APPROVED & LISTED  
 \* [www.truesdail.com](http://www.truesdail.com)

ROUGH-IN:

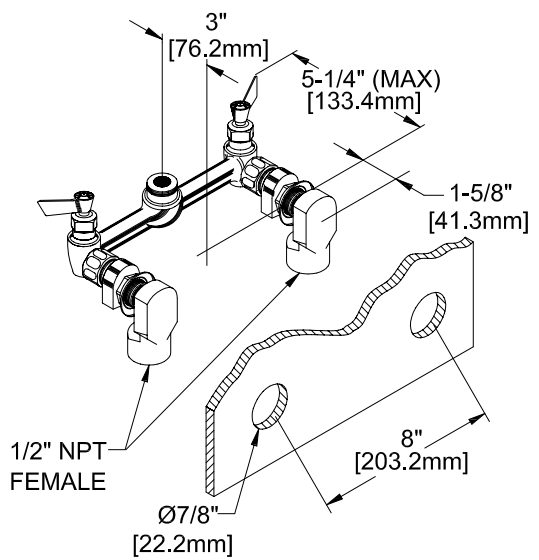

ANSI/A112.18.1M

**FISHER**  
 FISHER MANUFACTURING COMPANY  
 TOLL FREE: 800-421-6162 - FAX: 800-832-8238  
[information@fisher-mfg.com](mailto:information@fisher-mfg.com) - [www.fisher-mfg.com](http://www.fisher-mfg.com)